

note to self: get new darts

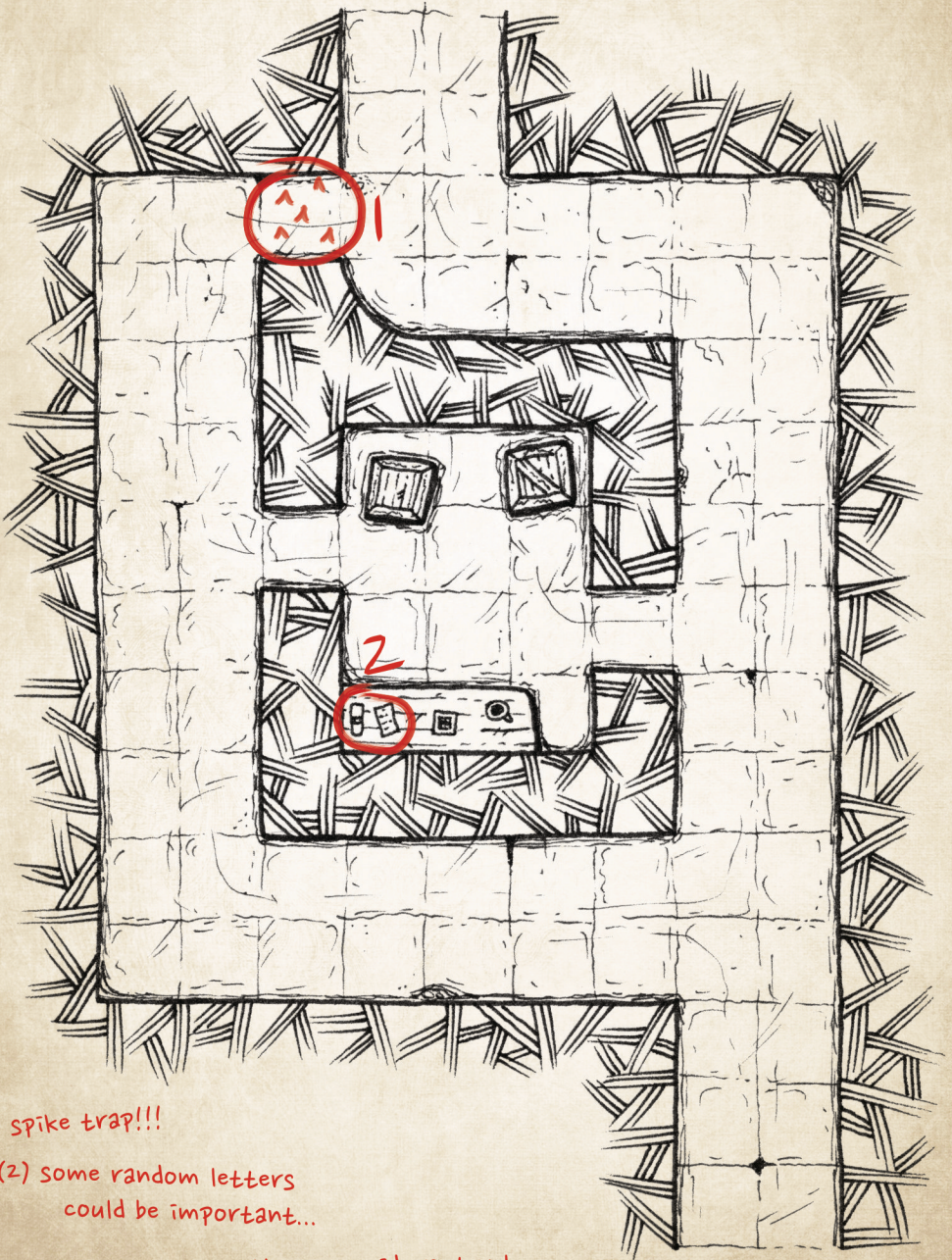

(1) spike trap!!!

(2) some random letters
could be important...

Something is roaming those corridors. I only
heard some steps - sounds like a rather small or
light creature

Nothing special to find here

(1) the broken bench is giving me a bad feeling though. Something big must have stepped on it.

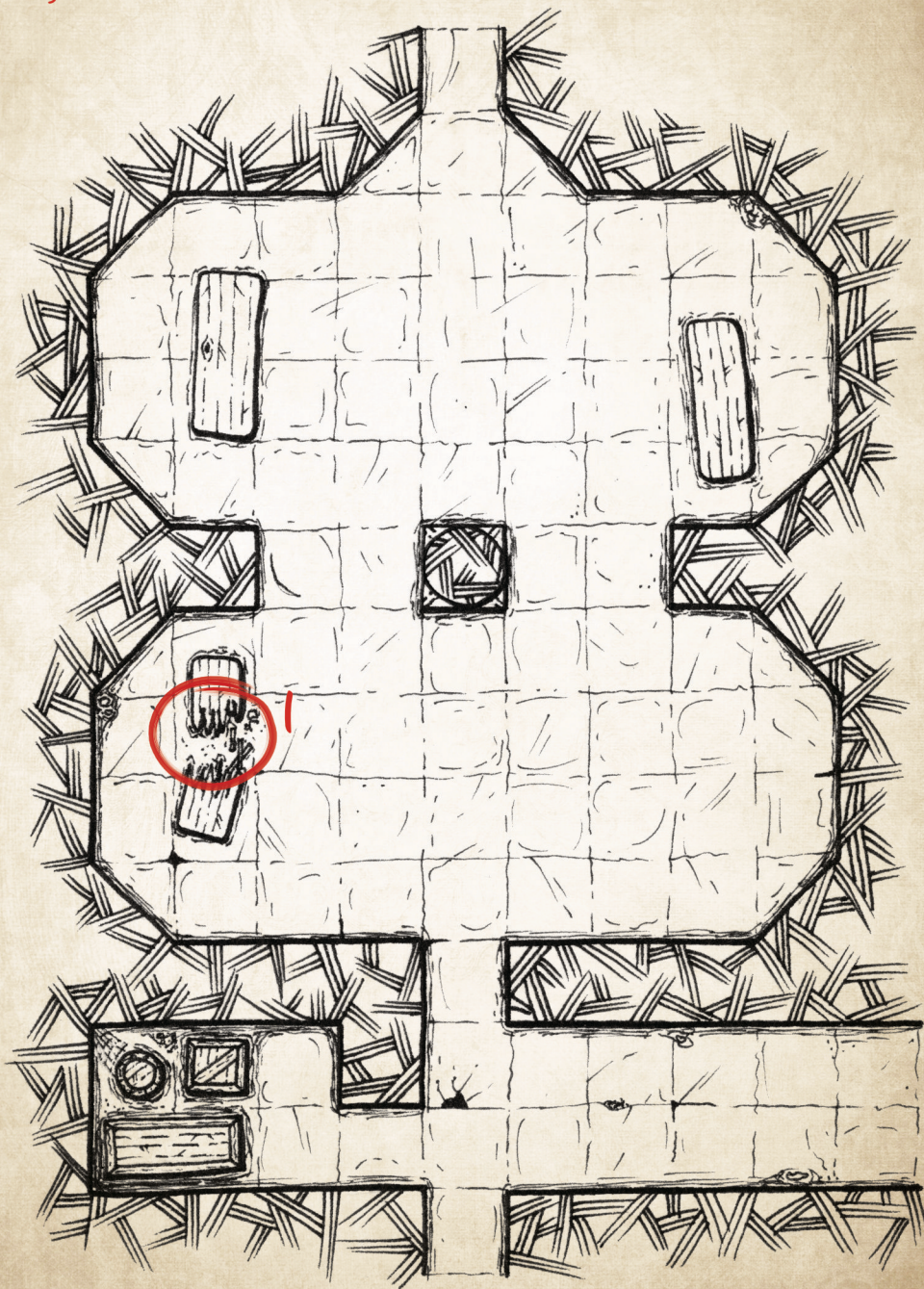

Thought about Aemula again... I wonder how she is at the moment.

(1) What would crawl through this hole? Nothing good I guess...

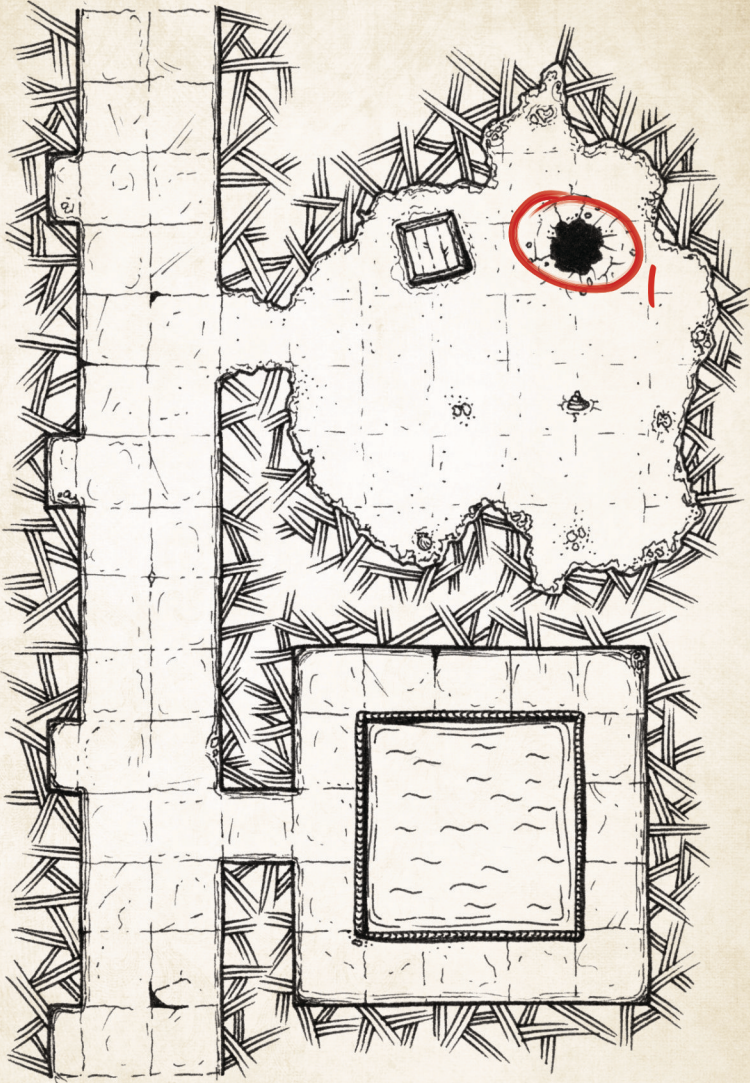

The water in the bath was clean and I took some time to clean myself and my clothes.

There seems to be some kind of system which replaces the water constantly. It got clean again just a few seconds after I was finished.

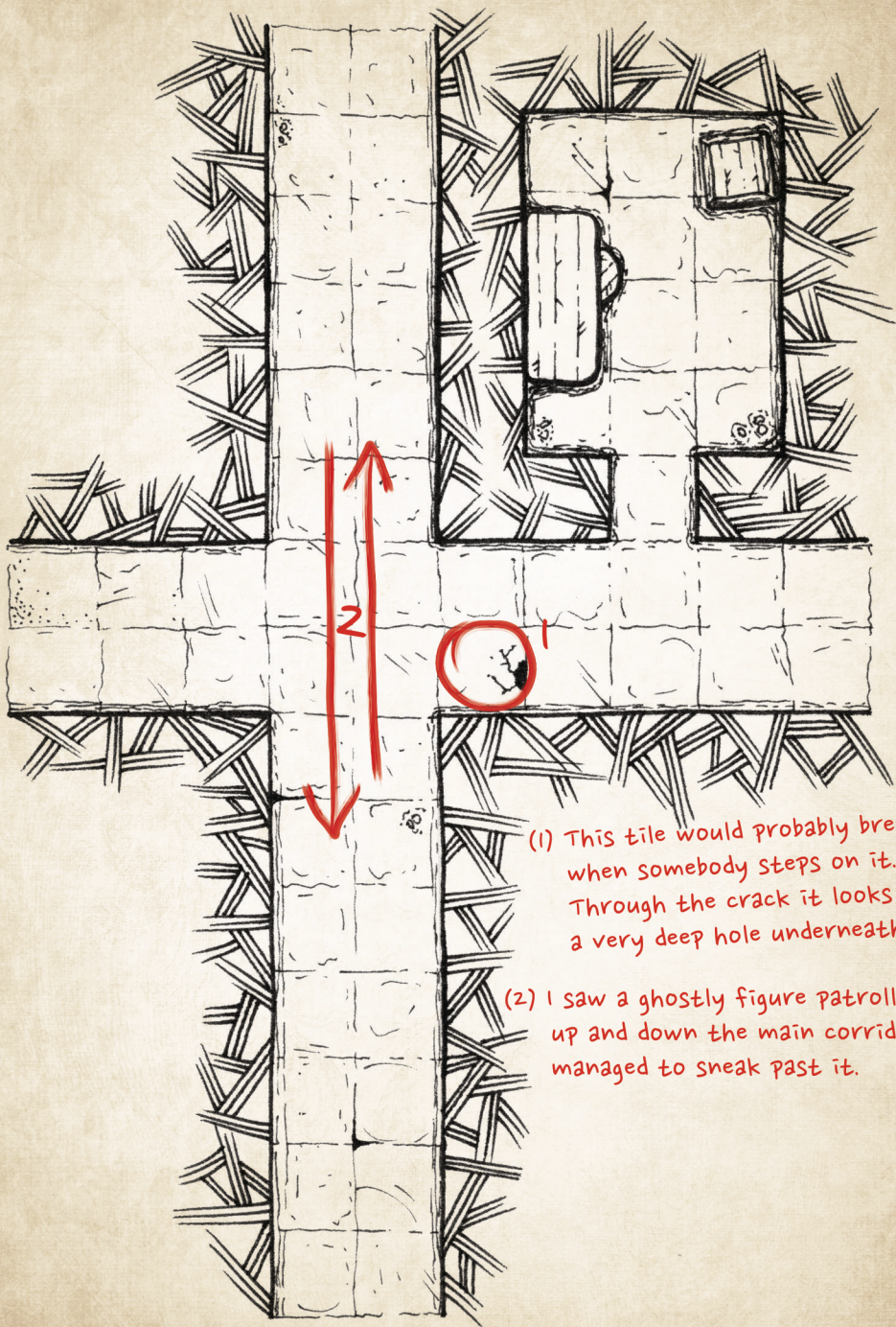

(1) This tile would probably break when somebody steps on it. Through the crack it looks like a very deep hole underneath.

(2) I saw a ghostly figure patrolling up and down the main corridor. managed to sneak past it.

Should I have asked Aemula out? I can't stop thinking about her!!!

Some sort of temple or chapel. Down here? Interesting...

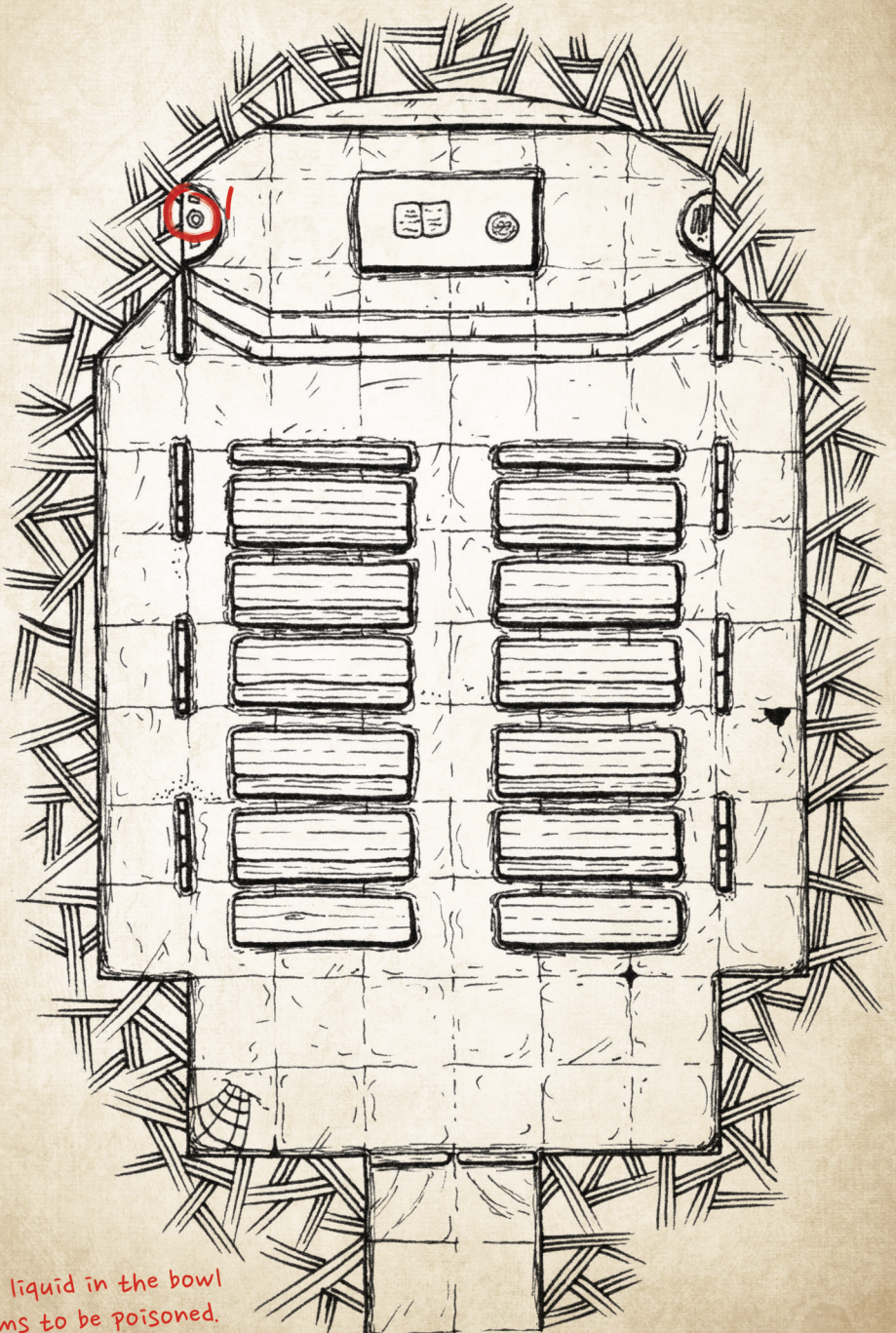

(1) The liquid in the bowl seems to be poisoned. What did they do down here?



(1) an unfinished letter.
looks like the author got
interrupted.

Found a very deep hole. couldn't even see to the bottom. But I swear I heard a
distant growling from below...

An abandoned mine. There is still some ore and tools to be found.
Everything looks intact and there is no sign of any reason why it's not
in use anymore.

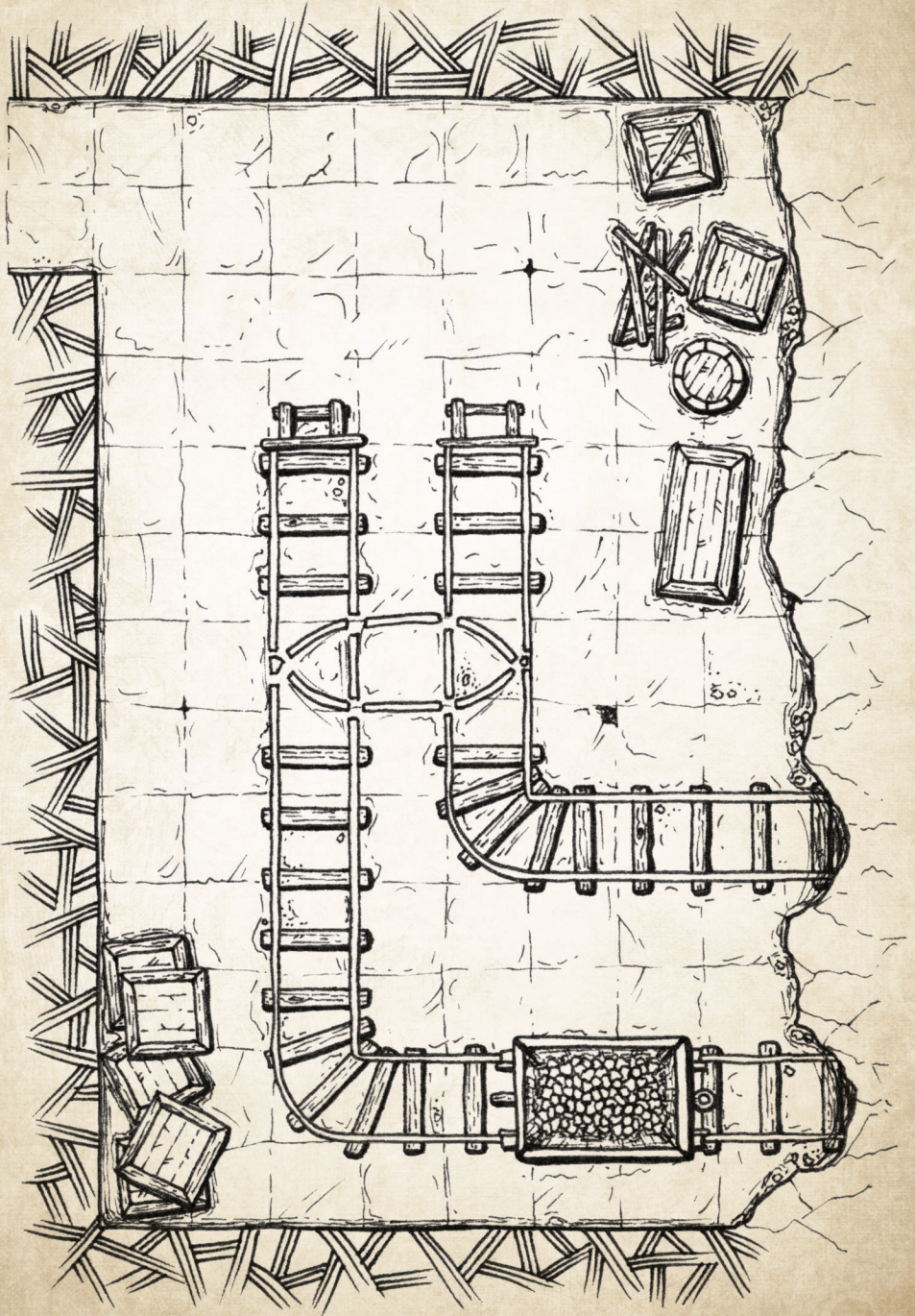

Forgot to buy those darts again...

The slimy ooze seems to be highly acidic. Better not touch it.
Luckily I was able to just jump over it. But others might have
a difficult time.

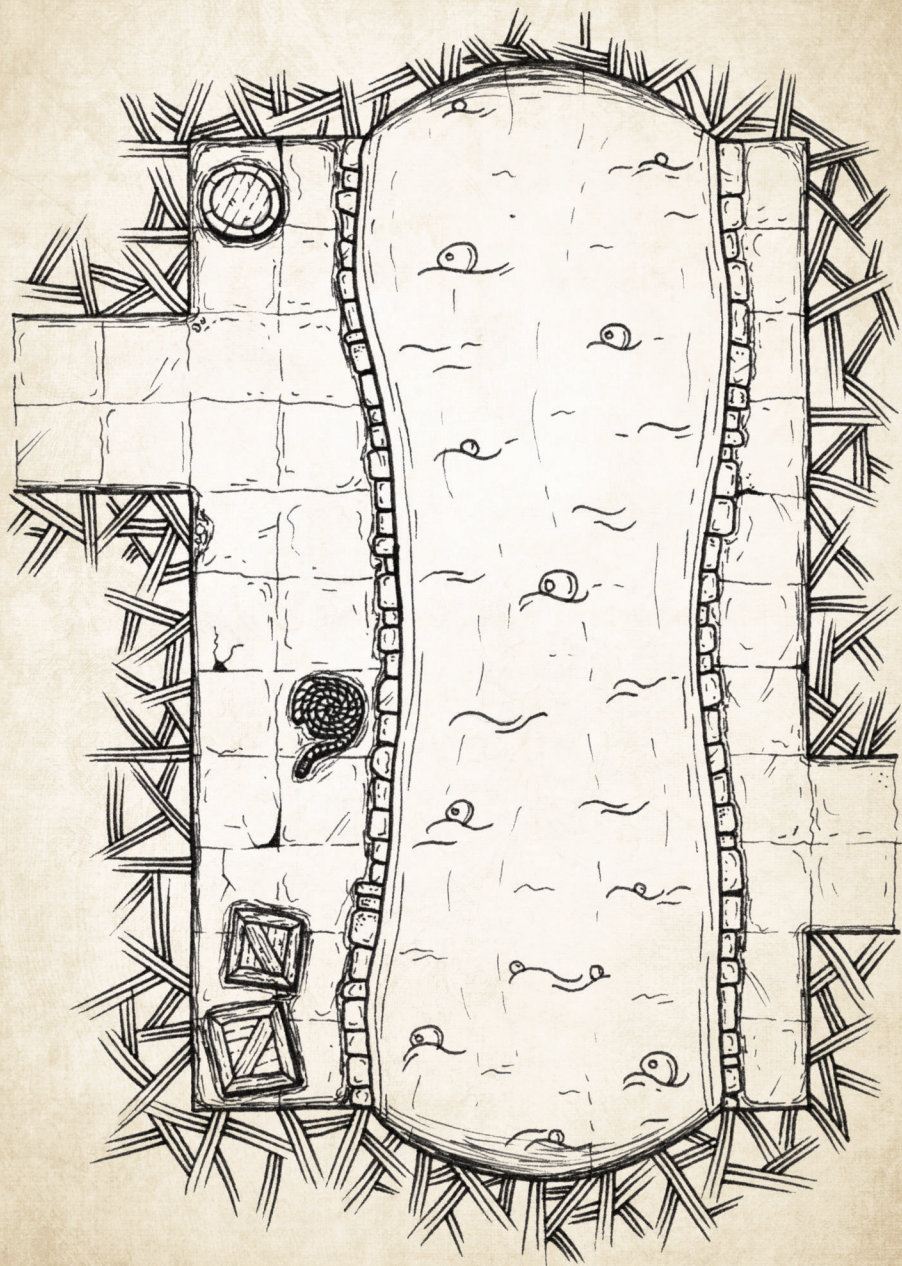

When I come back to Bellvale I will talk to her. For sure!

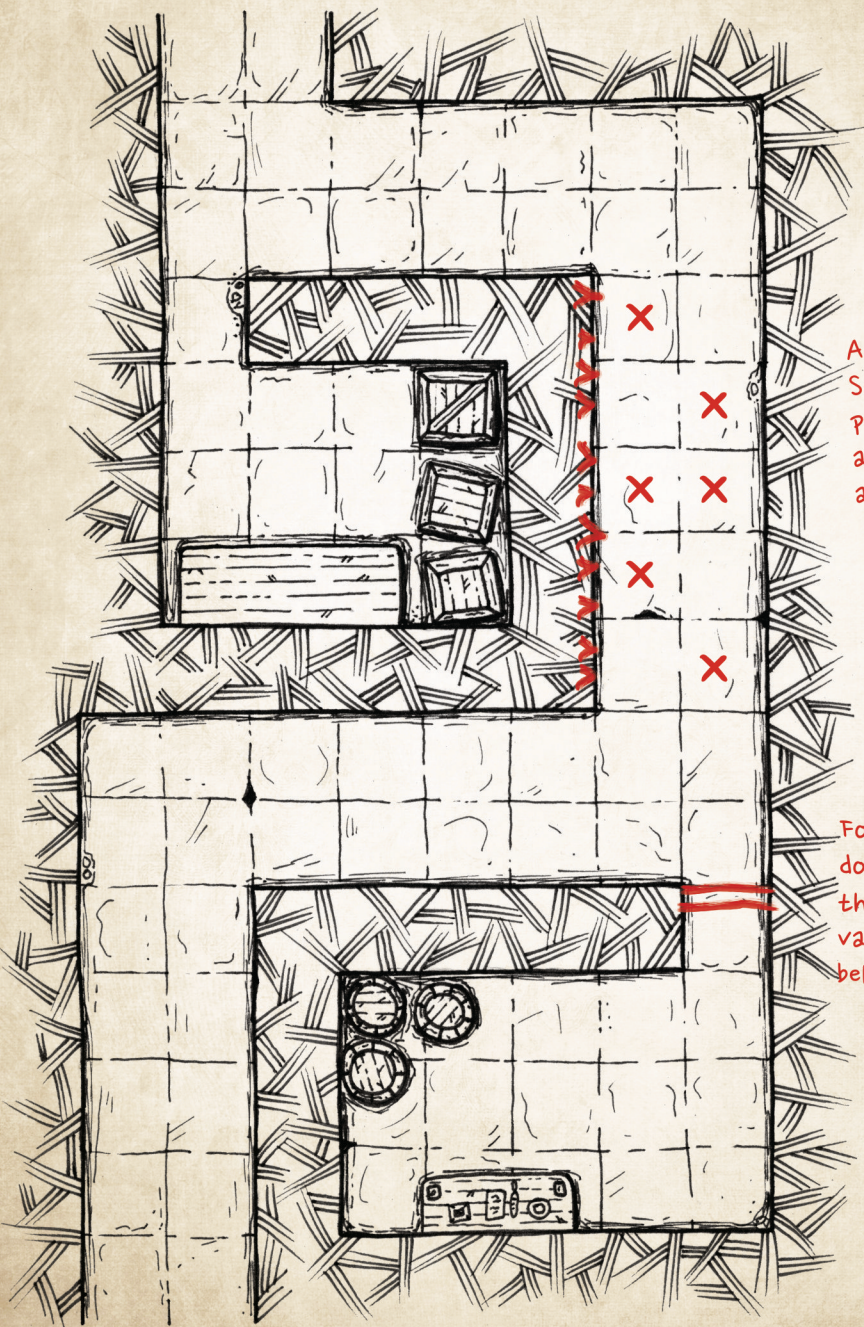

A nasty dart trap
Some plates (x) are
pressure sensitive
and the darts
are poisoned.

Found this secret
door. Looks like
there are some
valuables in the room
behind it.

(1) leaking barrel
the substance is flammable

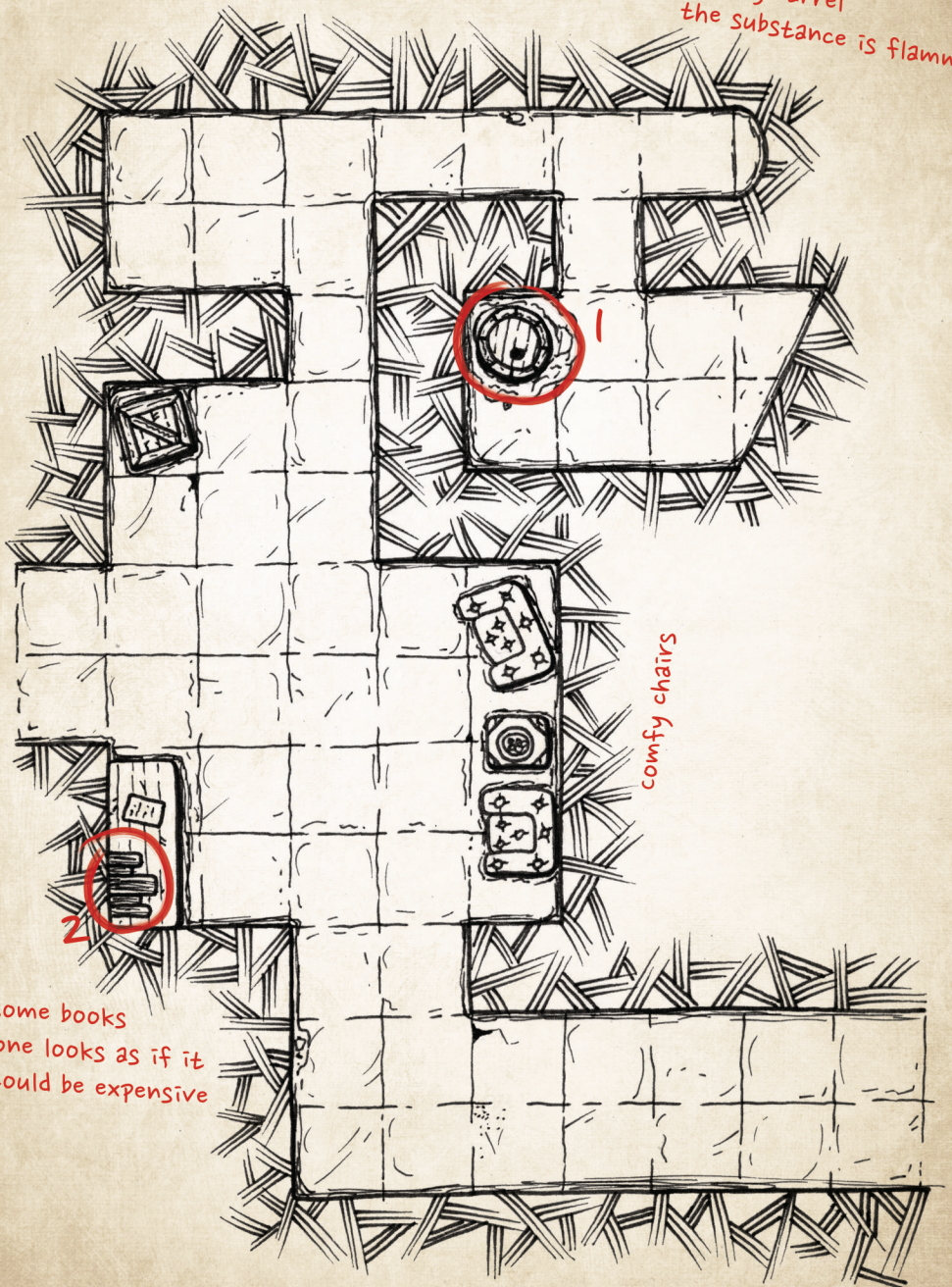

(2) some books
one looks as if it
could be expensive

note to self: read more books

Found an underground entrance to a mage tower. That's why you never see doors on them. clever wizards!

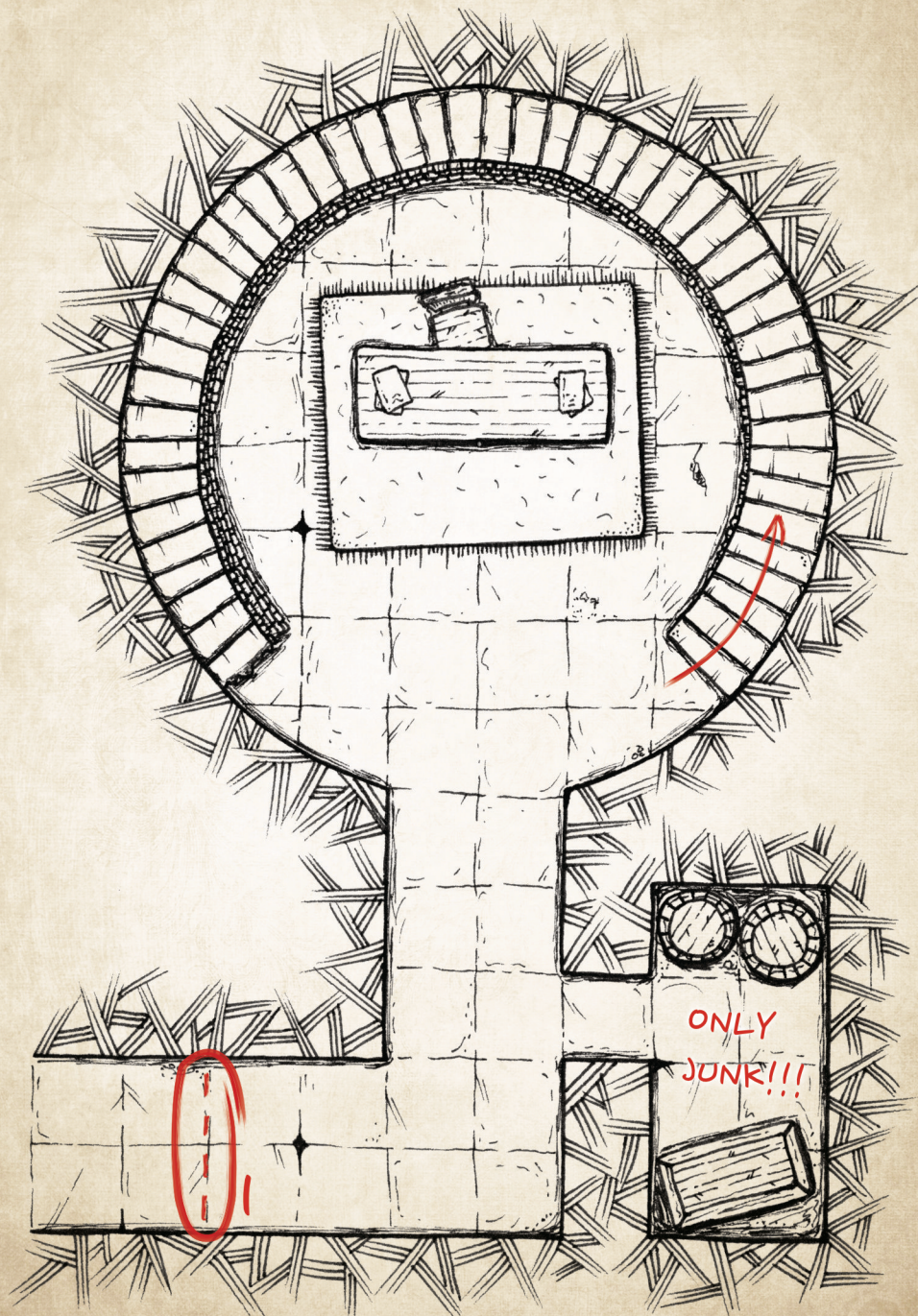

(1) Tripwire - will possibly cause an alarm

Note to self: Look under the rug in case you come back... you forgot it the first time!

FRICK! This is the first mage tower with anything interesting in it.
or maybe I didn't look hard enough. Just dusty books and a small casket
made out of stone. Is somebody messing with me?
The letters on the table also look worthless. This is not my day.
Nice view from the balcony though.

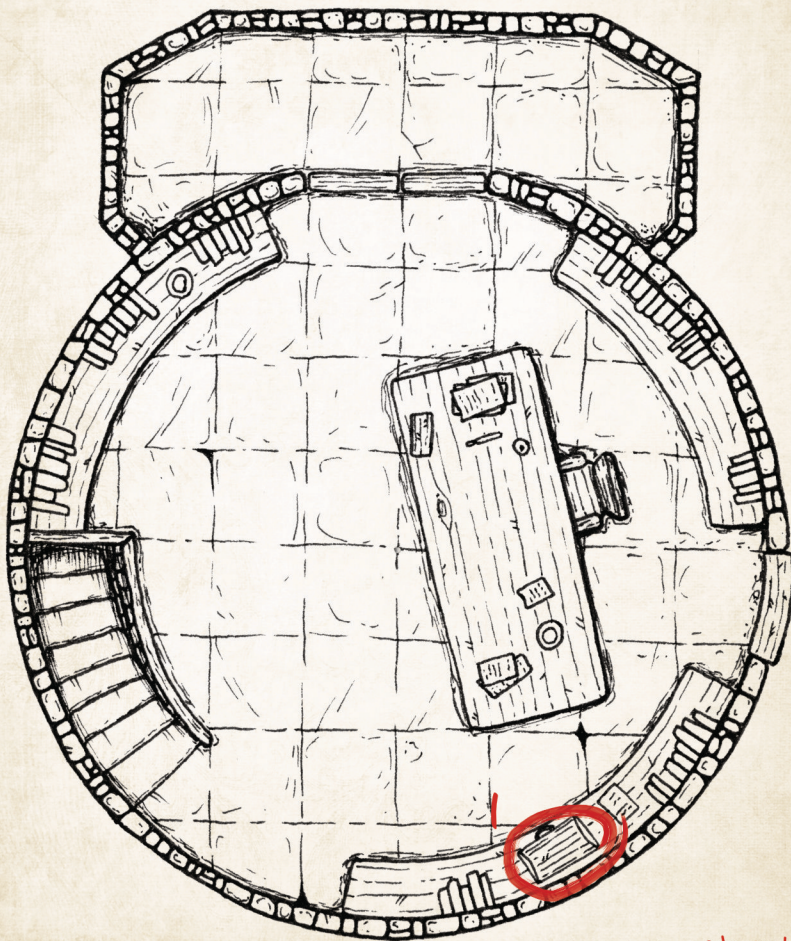

(1) A casket made out of stone
Is this a joke or a riddle?

Shopping List

- Darts
- Leather Patches
- Flowers for Aemula

Hand-drawn floor plan of a room with various furniture and annotations. The room is divided into several sections by walls and furniture.

- Top Right:** A small square object (possibly a trash can) is located near the top right corner. A red circle labeled "1" is drawn on the wall to its left. A red arrow points down to a red rectangular object (possibly a door or window) on the right wall.
- Top Left:** A red circle labeled "2" is drawn on the wall. A red arrow points down to a red rectangular object (possibly a door or window) on the left wall.
- Bottom Left:** A red circle labeled "3" is drawn on the wall. A red arrow points down to a red rectangular object (possibly a door or window) on the left wall.
- Bottom Right:** A red circle labeled "4" is drawn on the wall. A red arrow points down to a red rectangular object (possibly a door or window) on the right wall.
- Center:** A large rectangular area contains a desk with a chair, a small table with a chair, and a small square object (possibly a trash can).
- Annotations:**
 - Red text at the top right: "(1) pressure plate - trigger flamethrower".
 - Red text on the left: "are plate", "ers poison darts".
 - Red text at the bottom left: "illusion", "ole underneath".

Hand-drawn floor plan of a room with various furniture and annotations. The room is divided into several sections by walls and furniture.

- Top Right:** A small square object (possibly a pressure plate) is located near the top right corner. A red circle labeled "1" is drawn next to it, with the text "(1) pressure plate - trigger flamethrower" written above it.
- Center Left:** A red circle labeled "2" is drawn on the left wall. The text "pressure plate triggers poison darts" is written to its left.
- Bottom Left:** A red circle labeled "3" is drawn on the bottom left wall, with a large red 'X' over it. The text "illusion hole underneath" is written to its left.
- Bottom Right:** A red circle labeled "4" is drawn on the bottom right wall. Two red arrows point towards it from above and below, indicating a trap or mechanism.

The floor plan includes several pieces of furniture: a desk with a chair, a bed, a small table, and a large rectangular object (possibly a chest or table) in the center. The walls are decorated with a pattern of diagonal lines.

Hand-drawn floor plan of a room with various furniture and annotations. The room is divided into several sections by walls and furniture.

- Top Right:** A small square object (possibly a pressure plate) is located near the top right corner. A red circle labeled "1" is drawn next to it, with the text "(1) pressure plate - trigger flamethrower" written above it.
- Center Left:** A red circle labeled "2" is drawn on the left wall. The text "pressure plate triggers poison darts" is written to its left.
- Bottom Left:** A red circle labeled "3" is drawn on the bottom left wall, with a large red 'X' over it. The text "illusion hole underneath" is written to its left.
- Bottom Right:** A red circle labeled "4" is drawn on the bottom right wall. Two red arrows point towards it from above and below, indicating a trap or mechanism.

The floor plan includes several pieces of furniture: a desk with a chair, a bed, a small table, and a large rectangular object (possibly a chest or table) in the center. The walls are decorated with a pattern of diagonal lines.

Hand-drawn floor plan of a room with various furniture and annotations. The room is divided into several sections by walls and furniture.

- Top Right:** A small square object (possibly a pressure plate) is located near the top right corner. A red circle labeled "1" is drawn next to it, with the text "(1) pressure plate - trigger flamethrower" written above it.
- Center Left:** A red circle labeled "2" is drawn on the left wall. The text "pressure plate triggers poison darts" is written to its left.
- Bottom Left:** A red circle labeled "3" is drawn on the bottom left wall, with a large red 'X' over it. The text "illusion hole underneath" is written to its left.
- Bottom Right:** A red circle labeled "4" is drawn on the bottom right wall. Two red arrows point towards it from above and below, indicating a trap or mechanism.

The floor plan includes several pieces of furniture: a desk with a chair, a bed, a small table, and a large rectangular object (possibly a chest or table) in the center. The walls are decorated with a pattern of diagonal lines.

This really is the nicest dining room I have ever seen... And its underground.
What a waste. I imagine how it would look like with big colored windows and
a bright light shining through.

